

PARTS CATALOGUE

Cal.2B21A

Cal.2B21A (1j)

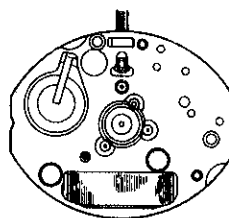
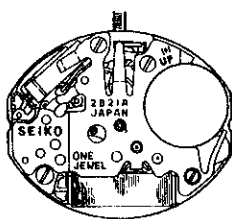

HATTORI SEIKO CO., LTD.

Cal.2B21A

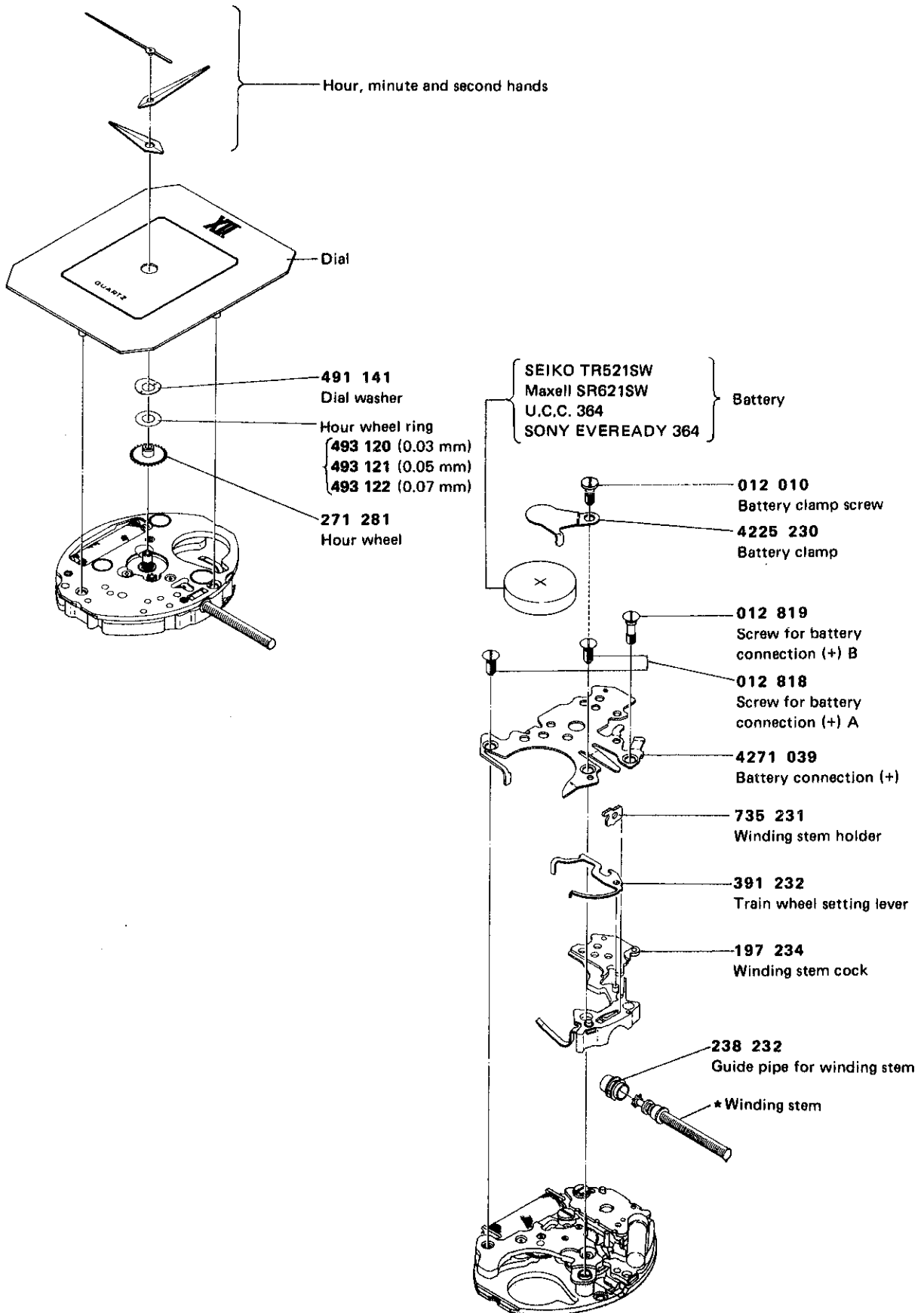



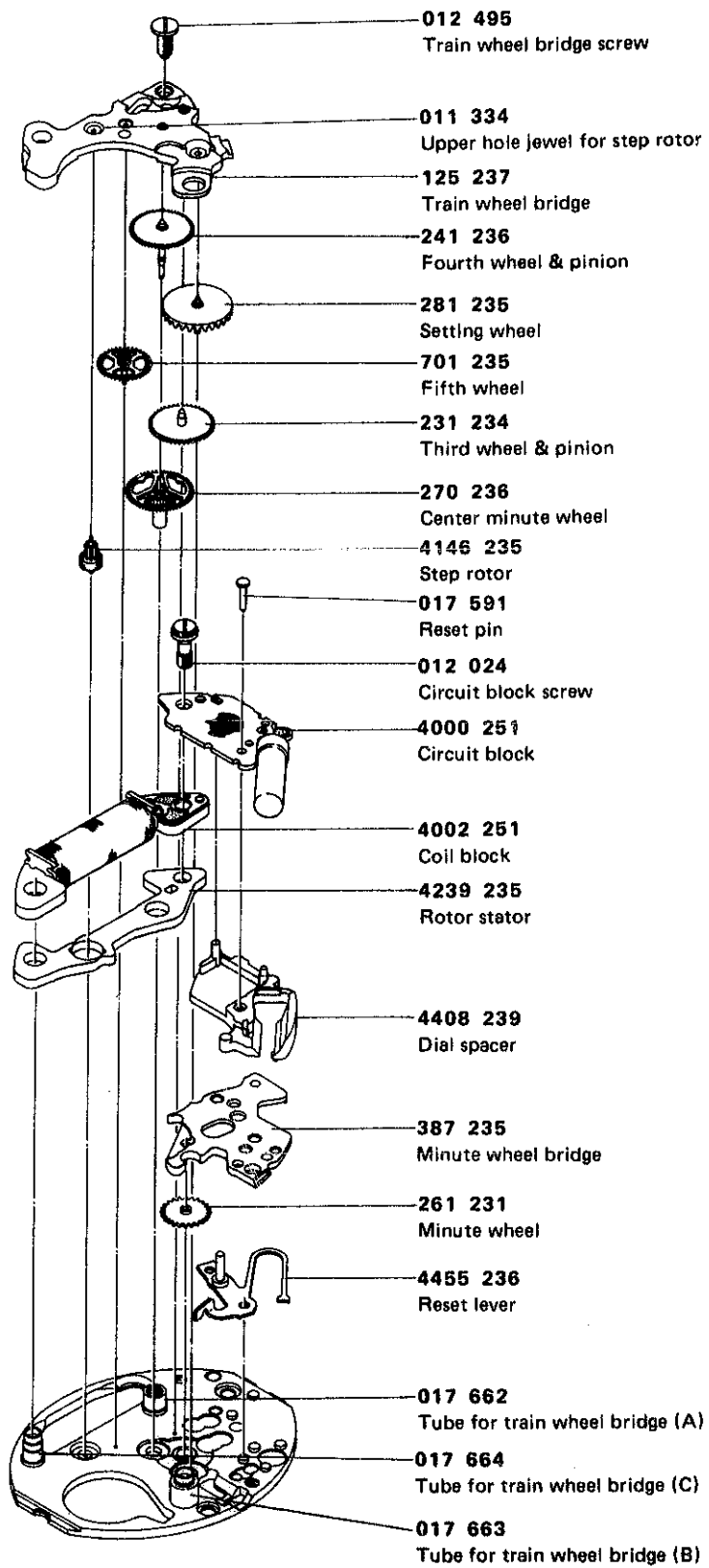

★ ⇨ Please see remarks on the last page.



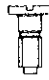
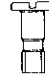

Remarks:

Winding stem

*354235 The type of winding stem is determined based on the design of cases and dials.
Check the case number and refer to "SEIKO Quartz Casing Parts Catalogue" to choose a corresponding winding stem.

 012 010	Battery clamp screw
 012 024	Circuit block screw
 012 495	Train wheel bridge screw
 012 818	Screw for battery connection (+) (A)
 012 819	Screw for battery connection (+) (B)

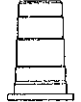
 017 591	Reset pin
 017 662	Tube for train wheel bridge (A)
 017 663	Tube for train wheel bridge (B)
 017 664	Tube for train wheel bridge (C)